



CMSD6001
 CMSD6001A
 CMSD6001C
 CMSD6001S

**SURFACE MOUNT
 LOW LEAKAGE SWITCHING DIODES**

SUPERmini™



SOT-323 CASE

• Device is *Halogen Free* by design

CMSD6001: SINGLE
CMSD6001A: DUAL, COMMON ANODE
CMSD6001C: DUAL, COMMON CATHODE
CMSD6001S: DUAL, IN-SERIES

MARKING CODE: 6C1
MARKING CODE: 61A
MARKING CODE: 61C
MARKING CODE: 61S

MAXIMUM RATINGS: (T_A=25°C)

	SYMBOL		UNITS
Continuous Reverse Voltage	V _R	75	V
Peak Repetitive Reverse Voltage	V _{RRM}	100	V
Continuous Forward Current	I _F	250	mA
Peak Repetitive Forward Current	I _{FRM}	250	mA
Forward Surge Current, t _p =1.0μs	I _{FSM}	4.0	A
Forward Surge Current, t _p =1.0s	I _{FSM}	1.0	A
Power Dissipation	P _D	275	mW
Operating and Storage Junction Temperature	T _J , T _{stg}	-65 to +150	°C
Thermal Resistance	θ _{JA}	455	°C/W

ELECTRICAL CHARACTERISTICS PER DIODE: (T_A=25°C unless otherwise noted)

SYMBOL	TEST CONDITIONS	MIN	MAX	UNITS
I _R	V _R =75V		500	pA
BV _R	I _R =100μA	100		V
V _F	I _F =1.0mA		0.85	V
V _F	I _F =10mA		0.95	V
V _F	I _F =100mA		1.1	V
C _T	V _R =0, f=1.0MHz		2.0	pF
t _{rr}	I _R =I _F =10mA, R _L =100Ω, Rec. to 1.0mA		3.0	μs

Central™

Semiconductor Corp.

DESCRIPTION:

The CENTRAL SEMICONDUCTOR CMSD6001 SERIES are silicon switching diodes manufactured by the epitaxial planar process, epoxy molded in a SUPERmini™ surface mount package, designed for switching applications requiring an extremely low leakage diode.

**SURFACE MOUNT
LOW LEAKAGE SWITCHING DIODES**

SOT-323 - MECHANICAL OUTLINE

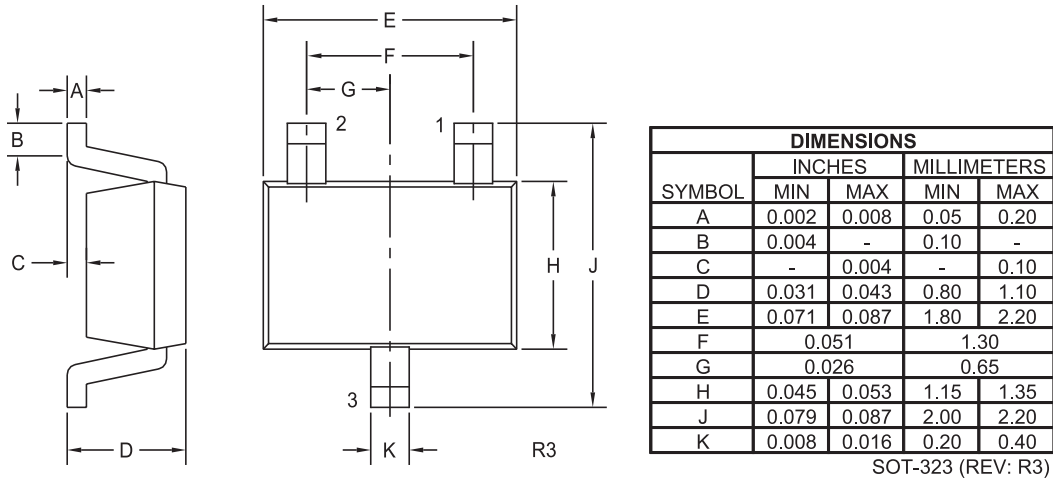

PIN CONFIGURATIONS

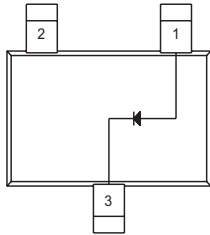

CMSD6001

LEAD CODE:

- 1) ANODE
- 2) NC
- 3) CATHODE

MARKING CODE: 6C1

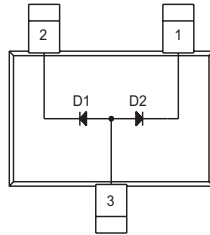

CMSD6001A

LEAD CODE:

- 1) CATHODE D2
- 2) CATHODE D1
- 3) ANODE D1, D2

MARKING CODE: 61A

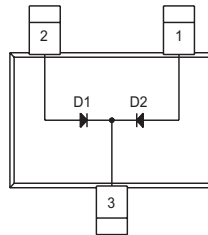

CMSD6001C

LEAD CODE:

- 1) ANODE D2
- 2) ANODE D1
- 3) CATHODE D1, D2

MARKING CODE: 61C

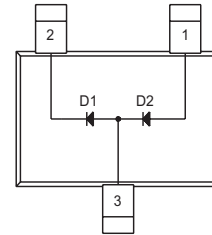

CMSD6001S

LEAD CODE:

- 1) ANODE D2
- 2) CATHODE D1
- 3) ANODE D1, CATHODE D2

MARKING CODE: 61S